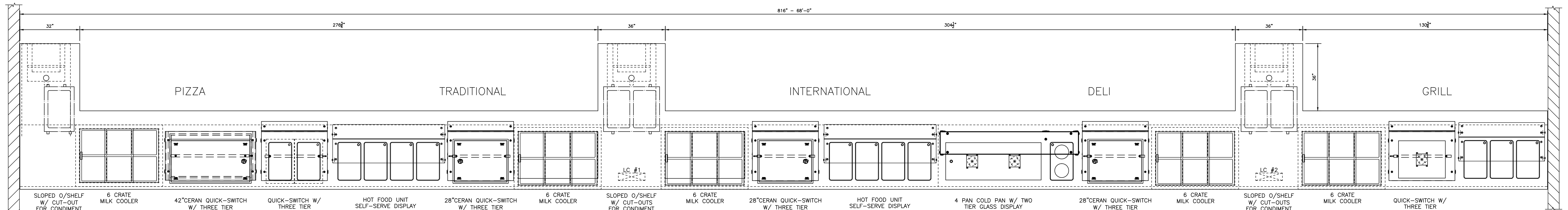
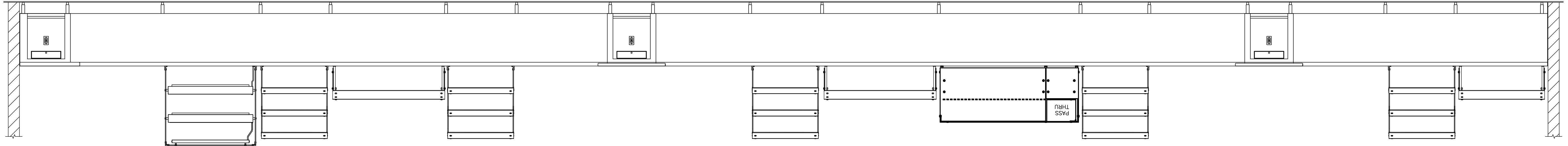

Information – Trade Package 11A – Kitchen Equipment

October 13, 2017

To: Trade Package 11A – Kitchen Equipment

Re: Information – Trade Package 11A – Kitchen Equipment 10/13/17
New Pierce County High School

The attached detail is offered as information to all bidders of Trade Package 11A – Kitchen Equipment.



- SLOPED O/SHELF W/ CUT-OUT FOR CONDIMENT PANS
- 6 CRATE MILK COOLER
- 42" CERAN QUICK-SWITCH W/ THREE TIER CERAN QUICK-SWITCH
- QUICK-SWITCH W/ THREE TIER VERSA-GARD DISPLAY
- HOT FOOD UNIT SELF-SERVE DISPLAY
- 28" CERAN QUICK-SWITCH W/ THREE TIER VERSA-GARD DISPLAY
- 6 CRATE MILK COOLER
- SLOPED O/SHELF W/ CUT-OUTS FOR CONDIMENT PANS
- 6 CRATE MILK COOLER
- 28" CERAN QUICK-SWITCH W/ THREE TIER VERSA-GARD DISPLAY
- HOT FOOD UNIT SELF-SERVE DISPLAY
- 4 PAN COLD PAN W/ TWO TIER GLASS DISPLAY PASS THRU @ SOUP
- 28" CERAN QUICK-SWITCH W/ THREE TIER VERSA-GARD DISPLAY
- 6 CRATE MILK COOLER
- SLOPED O/SHELF W/ CUT-OUTS FOR CONDIMENT PANS
- 6 CRATE MILK COOLER
- QUICK-SWITCH W/ THREE TIER VERSA-GARD DISPLAY

WINSTON HA4522

WINSTON HA4522

